

- Notes:**
1. Provide access points as necessary that allow routine maintenance of channels.
 2. Outlets should be provided where necessary. If required, see also RIW Ltds range of sumps and pumps, etc.

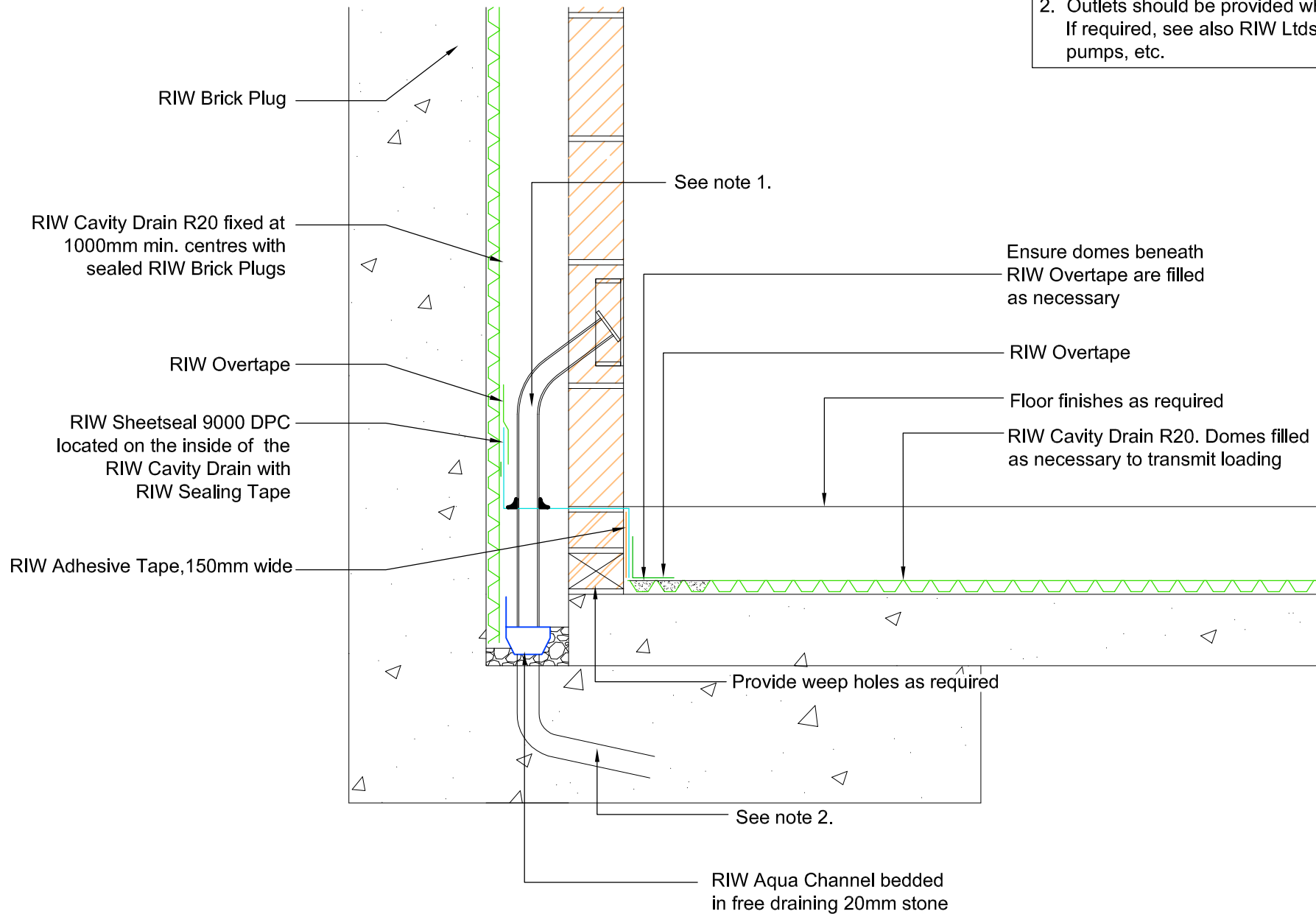

RIW CAVITY DRAIN:
TYPICAL WALL/FLOOR JUNCTION USING RIW AQUA CHANNEL

DRAWING NO: TD-CAV-102 A	
DATE: 12.02.13	SCALE: 1:10
DRAWN BY: SJB	CHECKED BY: DK