

**DAMP PROOFING:
STEEL FRAMING SYSTEM ON SLAB EDGE**

Notes:
1. Where the floor membrane is not subjected to hydrostatic pressure, then if preferred, DPM Blue may be used. Consult RIW for lapping / sealing details.

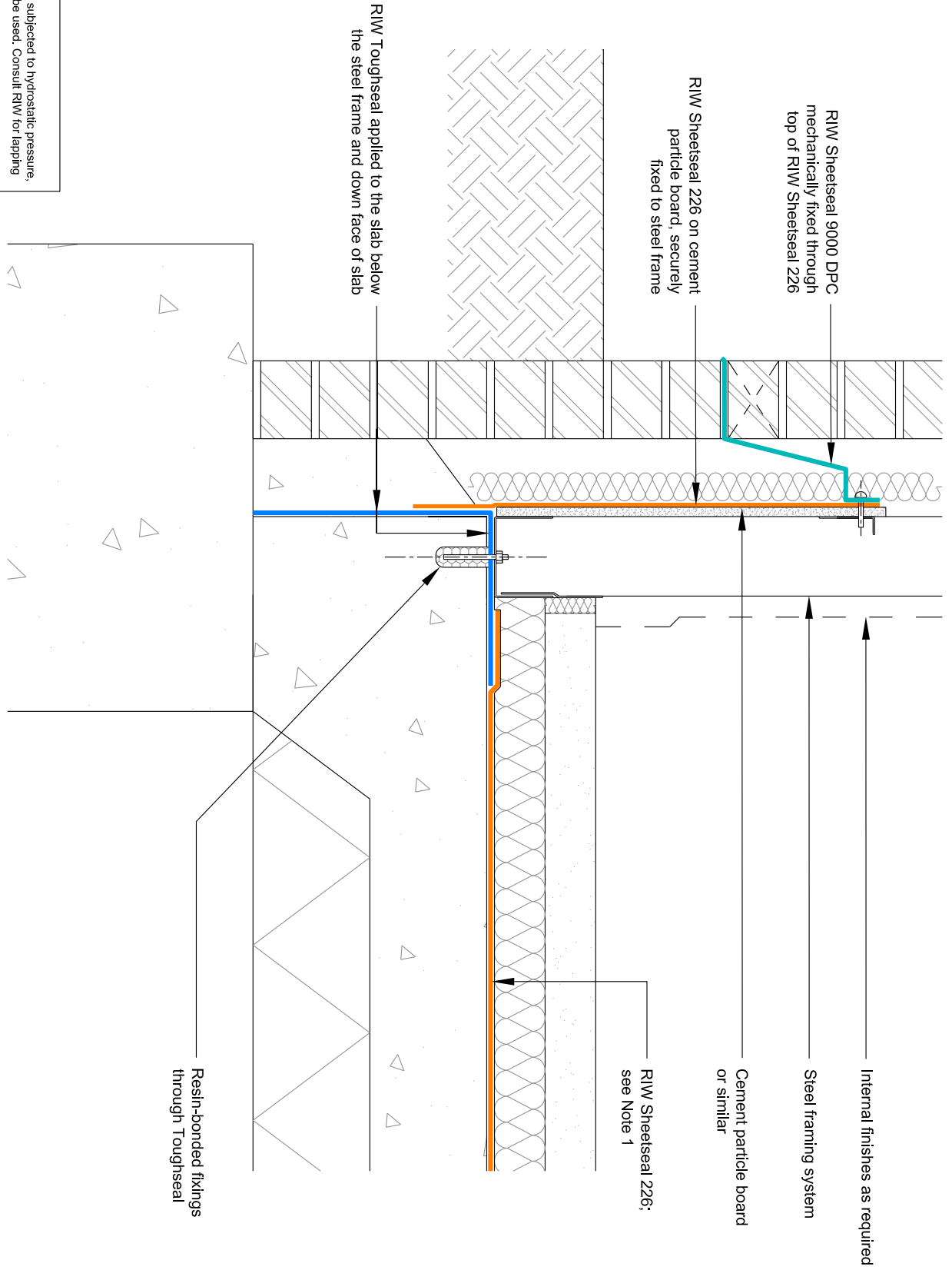

DRAWING NO: RIW/TD/301	SCALE: NTS
DATE: 18/08/2017	CHECKED BY: DK
DRAWN BY: RA	