

- Notes:
1. Concrete surfaces must be first treated with RIW Cementseal Primer, to reduce the risk of leaching of free lime or mineral salts.
  2. RIW Aqua Channel acts as a maintainable drainage channel, and must be installed including :
    - Outlets as required to discharge water ingress.
    - Provide 1 No. for every 50 linear metre run of channel, or 2 No. minimum.
    - Cleaning ports / Jetting eyes as required for maintenance. Provide at changes in direction, and at 12 metre maximum intervals between.
  3. RIW Aqua Channel should be placed in a recess to allow for the collection of water.
    - Recommended size = 130 x 130mm.
  4. RIW Aqua Channel can be bedded in 20mm minimum single sized aggregate, to secure it and promote drainage.
  5. RIW Brick Plugs fix the RIW Cavity Drain to the wall, and allow for fixing of screw-in type wall ties, etc.

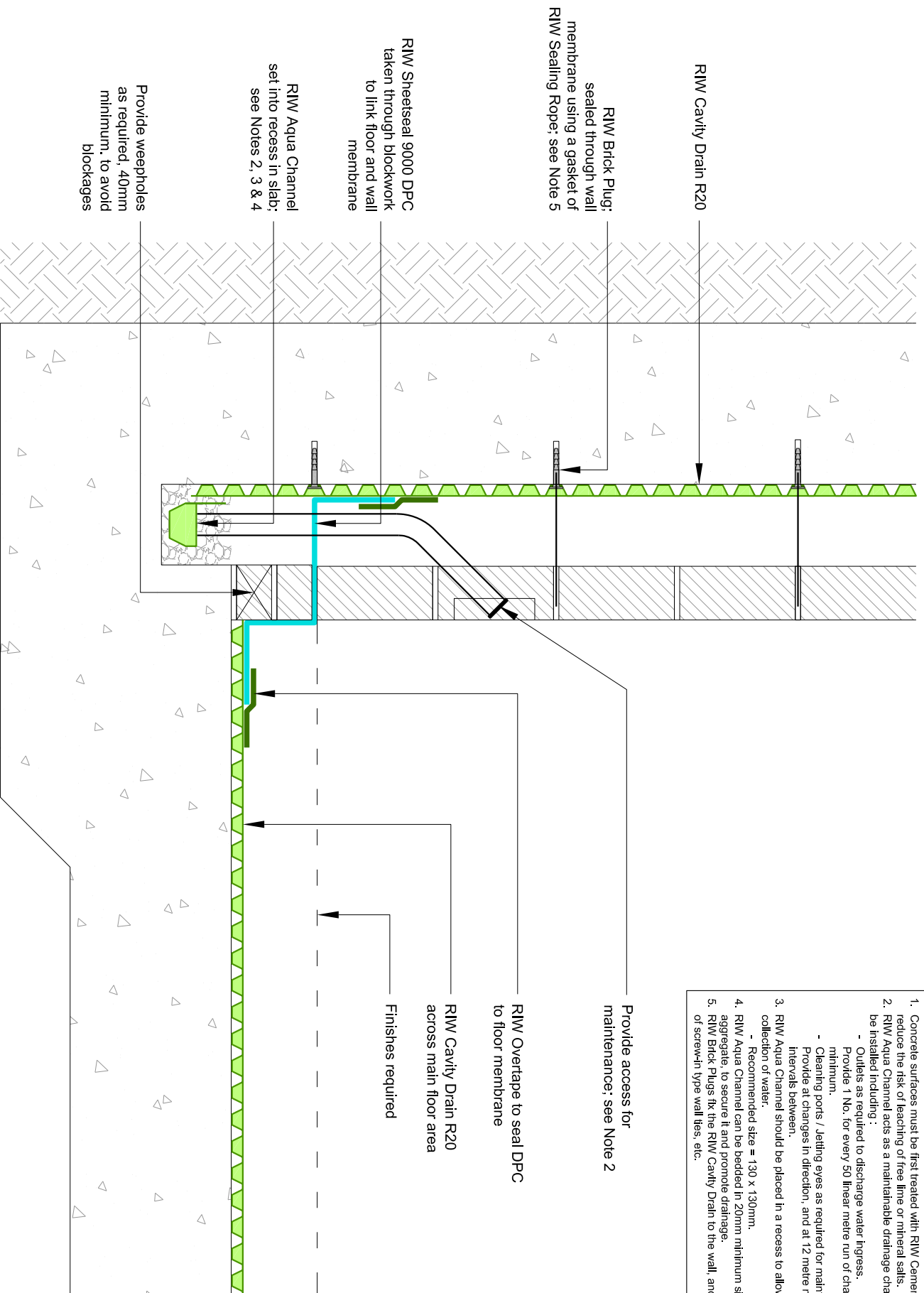

Provide access for maintenance; see Note 2

RIW Overtape to seal DPC to floor membrane

RIW Cavity Drain R20 across main floor area

Finishes required

RIW Brick Plug: sealed through wall membrane using a gasket of RIW Sealing Rope; see Note 5

RIW Cavity Drain R20

RIW Sheetseal 9000 DPC taken through blockwork to link floor and wall membrane

RIW Aqua Channel set into recess in slab; see Notes 2, 3 & 4

Provide weepholes as required, 40mm minimum, to avoid blockages