

RIW Sheetseal 9000 DPC taken through wall to link and sealed to floor membrane

RIW Overtape

RIW Double Drain R20; all domes filled to transmit loading

RIW Double Drain R20

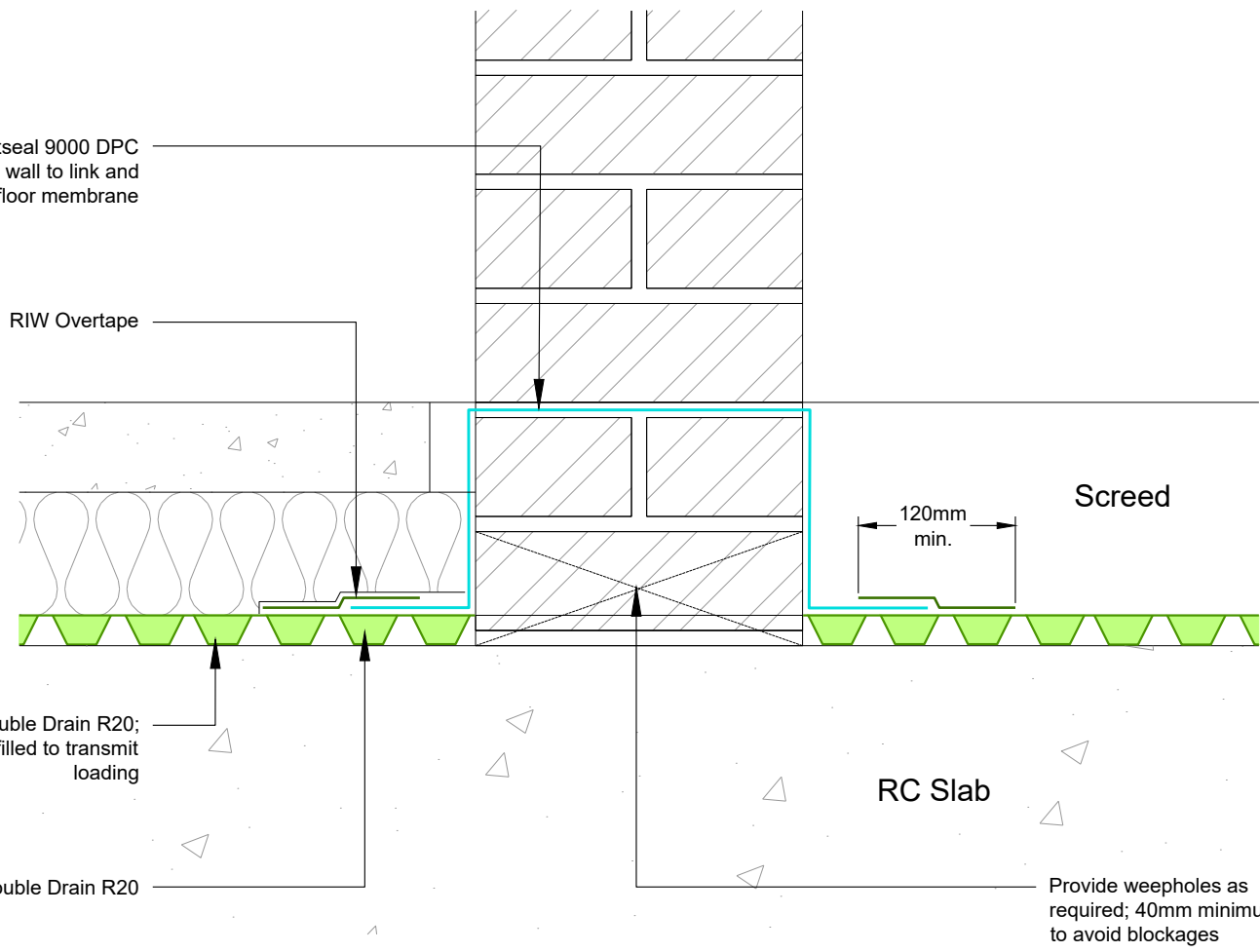

120mm min. Screed

RC Slab

Provide weepholes as required; 40mm minimum to avoid blockages

**SECTION**

**General Notes & Guidance:**

This drawing must be read in conjunction with the latest RIW Product Literature.

All waterproofing details shown herein must receive approval from the design team or appointed designer before implementation on site, these waterproofing details may have other impacts on the structure and these impacts must be assessed and understood by the design team or appointed designer.

BS8102:2009  
6.2.4 The need for continuity in the waterproofing protection should also be considered when selecting a type of protection. In most circumstances, the protection should be continuous.

**Drawing Notes:**

- BS8102:2009  
10.1 The outer leaf of the exterior wall should be capable of controlling the quantity of water that can pass through it, in order not to exceed the drainage capacity of the system. Water entering a drained cavity system is regulated by the structure, so defects that might result in unacceptable leaks should be remedied before the system is installed.



**RIW LTD**  
580 / 581 Ipswich Road, Slough, Berkshire, SL1 4EQ, UK  
T: +44 (0) 1753 944200 E: technical@riw.co.uk W: www.riw.co.uk

LAC® is a registered trademark of RIW Ltd. Flexiseal Pro, FWM, Heviseal, Toughseal, DPM Red, DPM Blue, Sheetseal 226, Structureseal, Cavitydrain R20, Cavitydrain R7, Gas Seal Black, Gas Seal HC, Sheetseal GR, Structureseal GPT, Sheetseal 9000, Cementjoint, Cementfill FC, Cementfill HB, Cementflex and Cementseal are all trademarks of RIW Ltd. Krystol Internal Membrane™ (Kim®), Krystol Waterstop Treatment™, Kyrtonite™ Swelling Waterstop and Krystol Waterstop Grout™, trademarks are the property of Kryton Inc.

This drawing is Copyright 2019 of RIW Ltd. Permission for copying is granted only to employees, authorised representatives, customers, and specifiers to support the sale or use of RIW Ltd products. All other rights are reserved.

Project:

Client:

Title:  
**RIW CAVITY DRAIN:  
LINK THROUGH INTERNAL MASONRY WALLS, USING SHEETSEAL 9000 DPC**

Additional Info:

Date:	Scale @ A4:	Drawn:	Checked:
19/09/19	NTS	RA	DK

Project Ref:	Drawing No:	Rev:
	RIW/TD/409	