

RIW CAVITY DRAIN: SEALED SYSTEM
RIW AQUA CHANNEL IN REBATE AT BOTTOM OF RETAINING WALL WITH DRY LINING

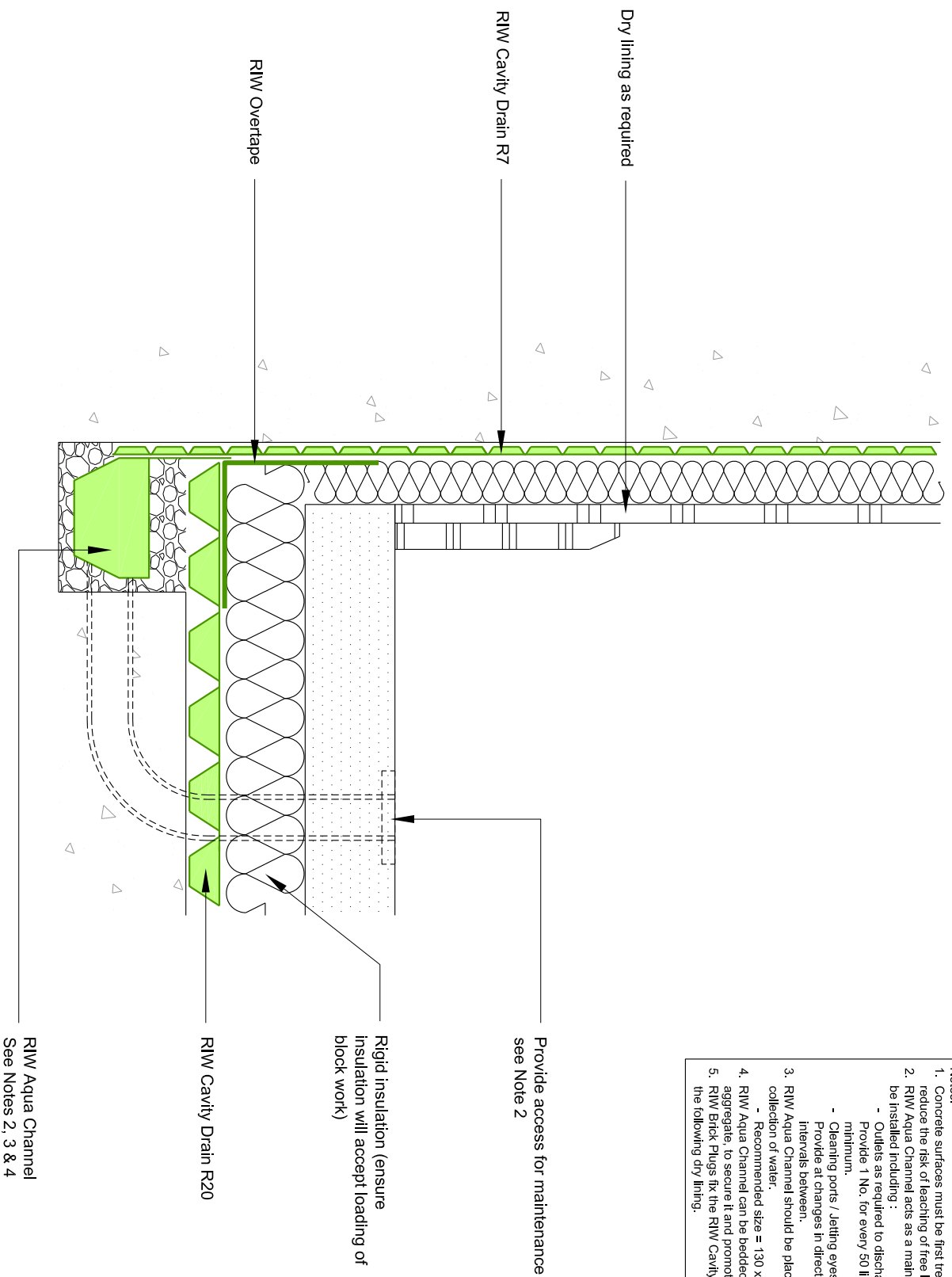

- Notes:**
1. Concrete surfaces must be first treated with RIW Cementseal Primer, to reduce the risk of leaching of free lime or mineral salts.
 2. RIW Aqua Channel acts as a maintainable drainage channel, and must be installed including :
 - Outlets as required to discharge water ingress.
 - Provide 1 No. for every 50 linear metre run of channel, or 2 No. minimum.
 - Cleaning ports / Jetting eyes as required for maintenance.
 3. RIW Aqua Channel should be placed in a recess to allow for the collection of water.
 - Recommended size = 130 x 130mm.
 4. RIW Aqua Channel can be bedded in 20mm minimum single sized aggregate, to secure it and promote drainage.
 5. RIW Brick Plugs fix the RIW Cavity Drain to the wall, and allow for fixing the following dry lining.

DRAWING NO:	RIW/TD/411	SCALE:	NTS
DATE:	24/10/2017	CHECKED BY:	DK
DRAWN BY:	RR		