

**PODIUM DECK:
TYPICAL JUNCTION AT MASONRY SUPERSTRUCTURE**

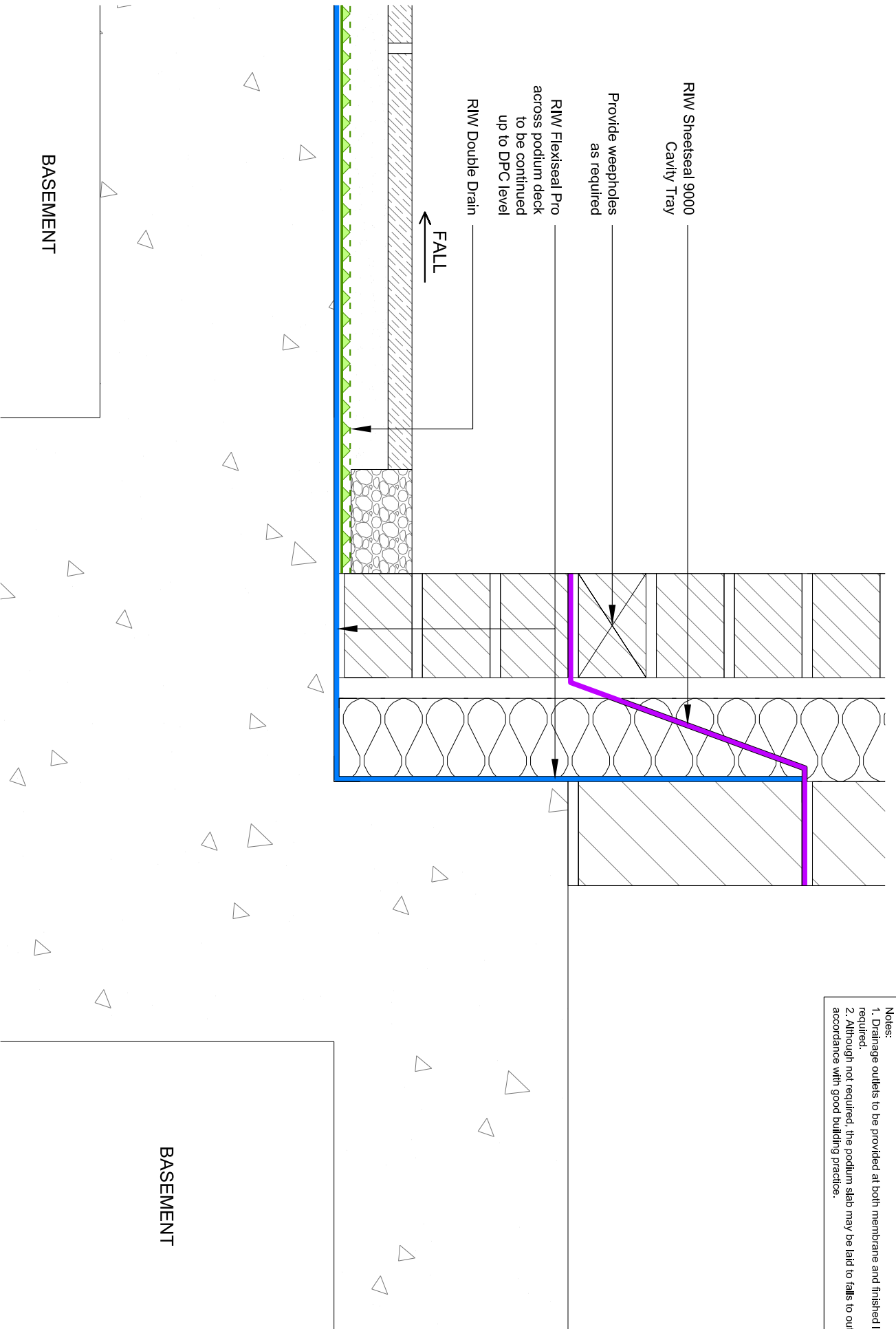

- Notes:**
1. Drainage outlets to be provided at both membrane and finished level as required.
 2. Although not required, the podium slab may be laid to falls to outlets; in accordance with good building practice.

DRAWING NO.: RIW-TD-601	SCALE: NTS
DATE: 22/09/2017	CHECKED BY: DK
DRAWN BY: RA	