

**General Notes & Guidance:**

This drawing must be read in conjunction with the latest RIW Product Literature.

All waterproofing details shown herein must receive approval from the design team or appointed designer before implementation on site, these waterproofing details may have other impacts on the structure and these impacts must be assessed and understood by the design team or appointed designer.

BS8102:2009

6.2.4 The need for continuity in the waterproofing protection should also be considered when selecting a type of protection. In most circumstances, the protection should be continuous.

**Drawing Notes:**

1. All gas membranes to be inspected and verified in accordance with Table 7 of BS8485:2015.
2. Ensure that any penetration details are sealed as per RIW's requirements. Please contact [technical@riw.co.uk](mailto:technical@riw.co.uk) or 01753 944200 for further assistance.
3. Sheetseal GR to be applied with reinforcing strips, etc.as required.
4. This detail provides vapour-proofing and gas-proofing only and is not suitable for hydrostatic pressure.
5. RIW only details masonry construction in conjunction with a wall drainage system to help reduce hydrostatic pressure acting on the structure. Drains should be subjected to regular inspections.
6. all brickwork/blockwork surfaces must be flush pointed to provide a smooth surface without sudden changes in level prior to RIW product application.

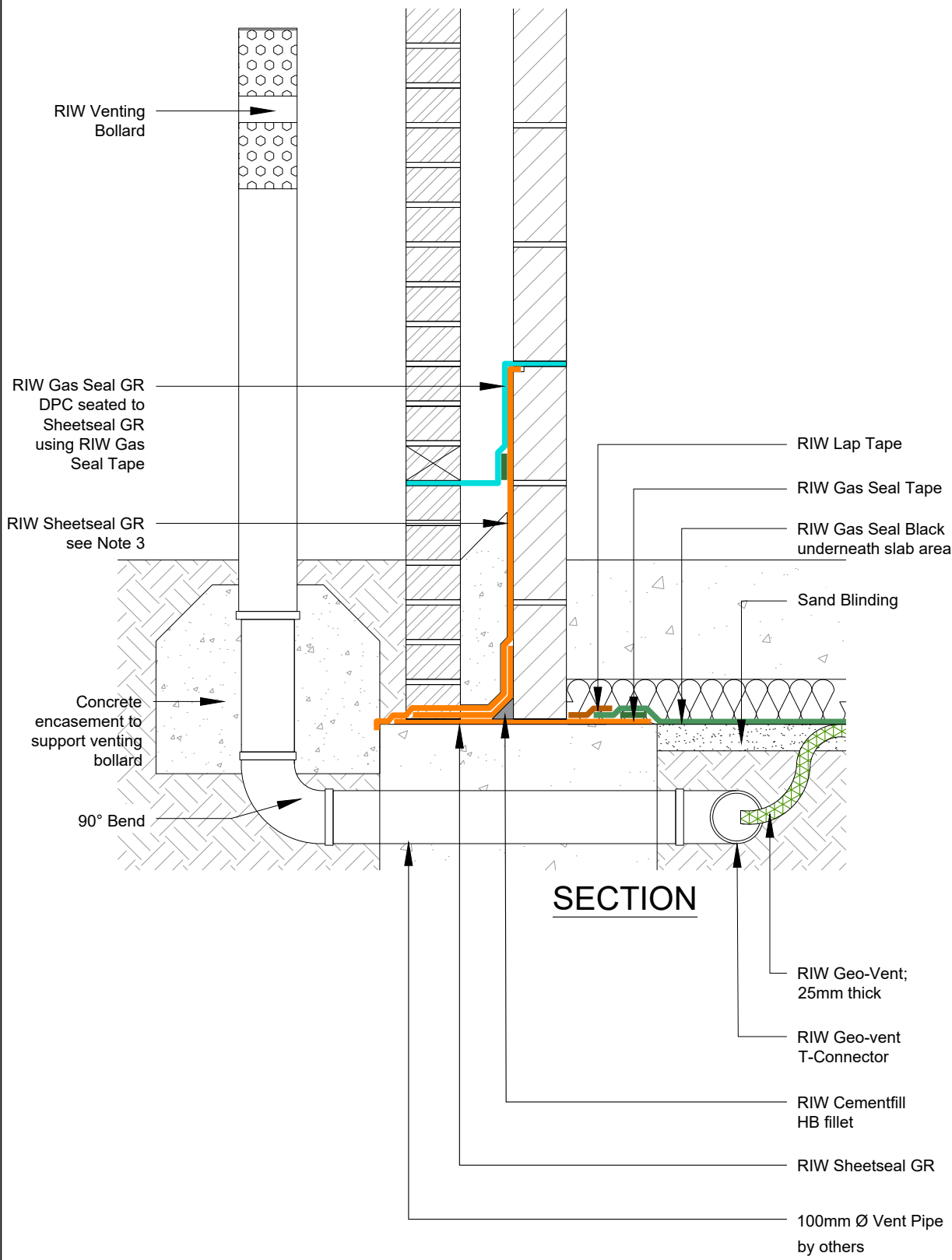

LAC® is a registered trademark of RIW Ltd. Flexiseal Pro, FWM, Heviseal, Toughseal, DPM Red, DPM Blue, Sheetseal 226, Structureseal, Cavitydrain R20, Cavitydrain R7, Gas Seal Black, Gas Seal HC, Sheetseal GR, Structureseal GPT, Sheetseal 9000, Cementjoint, Cementfill FC, Cementfill HB, Cementflex and Cementseal are all trademarks of RIW Ltd. Krystol Internal Membrane™ (Kim®), Krystol Waterstop Treatment™, Kyrtonite™ Swelling Waterstop and Krystol Waterstop Grout™, trademarks are the property of Kryton Inc.

This drawing is Copyright 2019 of RIW Ltd. Permission for copying is granted only to employees, authorised representatives, customers, and specifiers to support the sale or use of RIW Ltd products. All other rights are reserved.



**RIW LTD**  
580 / 581 Ipswich Road, Slough, Berkshire, SL1 4EQ, UK  
T: +44 (0) 1753 944200 E: [technical@riw.co.uk](mailto:technical@riw.co.uk) W: [www.riw.co.uk](http://www.riw.co.uk)

Project:	
Client:	
Title:	<b>GAS PROOFING: TYPICAL GROUND BEARING SLAB DETAIL WITH RIW GEO-VENT AND RIW VENTING BOLLARD</b>

Additional Info:			
Date:	Scale @ A4:	Drawn:	Checked:
19/09/19	NTS	RR	DK
Project Ref:	Drawing No:	Rev:	
	RIW/TD/802		